

BRONZE BOLTED EYE TERMINAL, DOUBLE OR SINGLE CABLE TO FLAT

SECTION

11-6

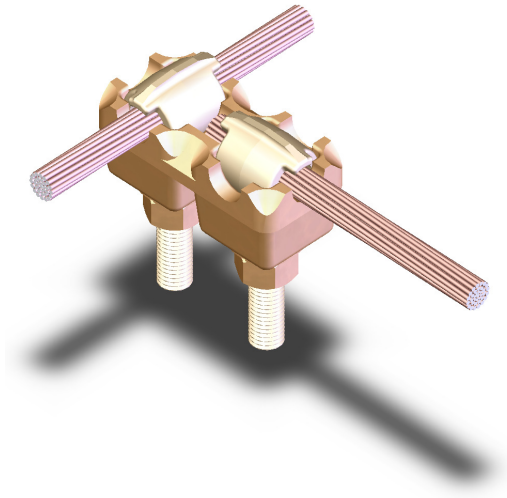
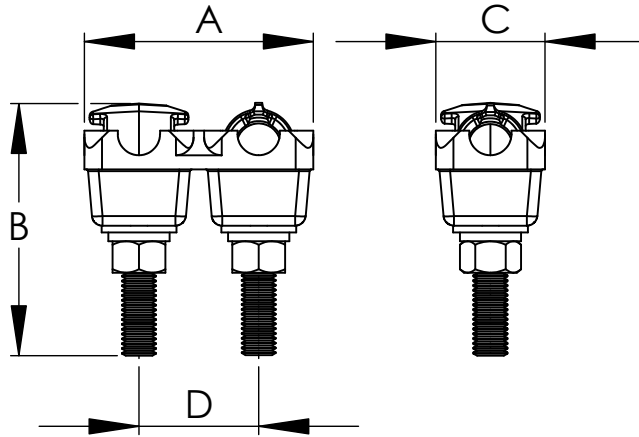

CATALOG NUMBER	CABLE SIZE		DIMENSIONS IN INCHES			
	AWG MIN.	MCM MAX.	A	B	C	D
TT-101A-2	8	250	3 1/4	4 1/4	1 5/8	1 3/4
TT-102A-2	1/0	500	3 1/8	3 3/4	1 1/4	1 3/4
TT-103A-2*	500	1000	4 1/4	4 1/2	2	2 1/4

Cast of a high conductivity copper alloy, these terminals are ideal for connecting one or two copper cables directly to a flat pad.

Designed for grounding or power applications.

* One way cup.