

BRONZE / ALUMINUM PARALLEL CABLE SPACERS

SECTION

110-1CS

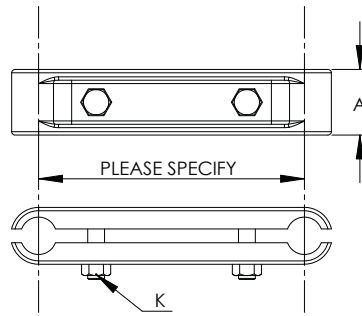

BRONZE CABLE SPACERS

CATALOG NUMBER	CABLE MAIN		2000 CABLE TAP		DIMENSIONS IN INCHES	
	AWG MIN	MCM MAX	AWG MIN	MCM MAX	A	K
110-101-CS*	4	250	4	250	1 1/4	3/8
110-103-CS*	250	500	250	500	1 7/8	1/2
110-105-CS*	500	1000	500	1000	2 1/8	1/2
110-107-CS*	1000	1500	1000	1500	2 1/8	5/8
110-110-CS*	1500	2000	1500	2000	2 3/8	5/8

Bronze Parallel Cable Spacers:

The type CS cable spacer connects a cable main parallel to a cable tap. It features a clamping member made of high strength, high conductivity copper alloy. The bolts, nuts, and lockwashers are silicon bronze to enhance clamping efficiency and resistance to corrosion.

Note: To obtain a cable spacer for (2) 300 MCM copper conductors spaced at 8" add suffix "-8"

Example: 110-103-CS-8.

*Please specify cable spacing (in.)

Aluminum Parallel Cable Spacers:

A high strength, high conductivity aluminum cable spacer, the type CSA includes clamping hardware made of high-tensile aluminum for dependability and durability in the field. To facilitate installation, all bolt heads are captivated. Width (A) will vary with length.



ALUMINUM CABLE SPACERS

CATALOG NUMBER	AAC AWG OR MCM		ACSR AWG OR MCM		DIMENSIONS IN INCHES	
	MIN-MAX	MIN-MAX	MIN-MAX	MIN-MAX	A	K
110-111-CS*	4-250(37)	4-250(37)	4(6/1)-4/0(6/1)	4(6/1)-4/0(6/1)	1 3/4	1/2
110-113-CS*	250(7)-400(37)	250(7)-400(37)	4/0(6/1)-336.4(26/7)	4/0(6/1)-336.4(26/7)	1 3/4	1/2
110-115-CS*	350(19)-600(61)	350(19)-600(61)	336.4(18/1)-477(30/7)	336.4(18/1)-477(30/7)	1 3/4	1/2
110-117-CS*	600(61)-900(61)	600(61)-900(61)	556.5(18/1)-795(54/7)	556.5(18/1)-795(54/7)	1 3/4	1/2
110-119-CS*	900(61)-1250(91)	900(61)-1250(91)	715.5-1113	715.5-1113	2 1/8	5/8
110-121-CS*	1272(61)-1590(61)	1272(61)-1590(61)	1113-1250	1113-1250	2 1/8	5/8
110-123-CS*	1590(61)-2000(127)	1590(61)-2000(127)	1272-1590	1272-1590	2 1/8	5/8

*Please specify cable spacing (in.)