

BRONZE STUD CONNECTORS STUD TO CABLE

SECTION

14-2

CATALOG NUMBER	STUD SIZE	AWG MIN	MCM MAX	DIMENSIONS IN INCHES			
				A	B	C	K
14-231*	1/2-13	8	600	5 1/8	2	3 1/8	3/8
14-232*	5/8-11	8	600	5 1/8	2	3 1/8	3/8
14-233*	3/4-16	8	600	5 1/8	2	3 1/8	3/8
14-235*	1-14	8	600	5 3/8	2 1/4	3 1/8	1/2 & 3/8
14-236*	1-14	4/0	1000	6	2 1/4	3 3/4	1/2
14-238*	1 1/8-12	8	600	5 3/8	2 1/4	3 1/8	1/2 & 3/8
14-239*	1 1/8-12	4/0	1000	6	2 1/4	3 3/4	1/2
14-241*	1 1/4-12	8	600	5 1/2	2 1/2	3 1/8	1/2 & 3/8
14-242*	1 1/4-12	4/0	1000	6 1/4	2 1/2	3 3/4	1/2
14-244*	1 1/2-12	8	600	5 5/8	2 1/2	3 1/8	1/2 & 3/8
14-245*	1 1/2-12	4/0	1000	6 1/4	2 1/2	3 3/4	1/2
14-246	1 1/2-12	1000	1500	6 3/4	2 1/2	4 1/4	1/2
14-244S*	1 3/4-12	8	600	5 5/8	2 1/2	3 1/8	1/2 & 3/8
14-245S	1 3/4-12	4/0	1000	6 1/4	2 1/2	3 3/4	1/2
14-246S	1 3/4-12	1000	1500	6 3/4	2 1/2	4 1/4	1/2
14-247*	2-12	8	600	5 5/8	2 1/2	3 1/8	5/8 & 3/8
14-248*	2-12	4/0	1000	6 1/4	2 1/2	3 3/4	5/8 & 1/2
14-249	2-12	1000	1500	6 3/4	2 1/2	4 1/4	5/8 & 1/2
14-250	2-12	1500	2000	7 5/8	2 1/2	5 1/8	5/8 & 1/2
14-251*	2 1/4-12	8	600	5 5/8	2 1/2	3 1/8	5/8 & 3/8
14-252*	2 1/4-12	4/0	1000	6 1/4	2 1/2	3 3/4	5/8 & 1/2
14-253	2 1/4-12	1000	1500	6 3/4	2 1/2	4 1/4	5/8 & 1/2
14-254	2 1/4-12	1500	2000	7 5/8	2 1/2	5 1/8	5/8 & 1/2
14-255*	2 1/2-12	8	600	5 5/8	2 1/2	3 1/8	5/8 & 3/8
14-256*	2 1/2-12	4/0	1000	6 1/4	2 1/2	3 3/4	5/8 & 1/2
14-257	2 1/2-12	1000	1500	6 3/4	2 1/2	4 1/4	5/8 & 1/2
14-258	2 1/2-12	1500	2000	7 5/8	2 1/2	5 1/8	5/8 & 1/2
14-259*	2 3/4-12	8	600	6 3/8	3 1/4	3 1/8	5/8 & 3/8
14-260*	2 3/4-12	4/0	1000	7	3 1/4	3 3/4	5/8 & 1/2
14-261	2 3/4-12	1000	1500	7 1/2	3 1/4	4 1/4	5/8 & 1/2
14-262	2 3/4-12	1500	2000	8 3/8	3 1/4	5 1/8	5/8 & 1/2
14-263*	3-12	8	600	6 3/8	3 1/4	3	5/8 & 3/8
14-264*	3-12	4/0	1000	7	3 1/4	3 3/4	5/8 & 1/2
14-265	3-12	1000	1500	7 1/2	3 1/4	4 1/4	5/8 & 1/2
14-266	3-12	1500	2000	8 3/8	3 1/4	5 1/8	5/8 & 1/2
14-267*	3 1/4-12	4/0	1000	7	3 1/4	3 3/4	5/8 & 1/2
14-268	3 1/4-12	1000	1500	7 1/2	3 1/4	4 1/4	5/8 & 1/2
14-269	3 1/4-12	1500	2000	8 3/8	3 1/4	5 1/8	5/8 & 1/2
14-270*	3 1/2-12	4/0	1000	7 1/4	3 1/2	3 3/4	5/8 & 1/2
14-271	3 1/2-12	1000	1500	7 3/4	3 1/2	4 1/4	5/8 & 1/2
14-272	3 1/2-12	1500	2000	8 5/8	3 1/2	5 1/8	5/8 & 1/2
14-273*	4-12	4/0	1000	7 1/4	3 1/2	3 3/4	5/8 & 1/2
14-274	4-12	1000	1500	7 3/4	3 1/2	4 1/4	5/8 & 1/2
14-275	4-12	1500	2000	8 5/8	3 1/2	5 1/8	5/8 & 1/2

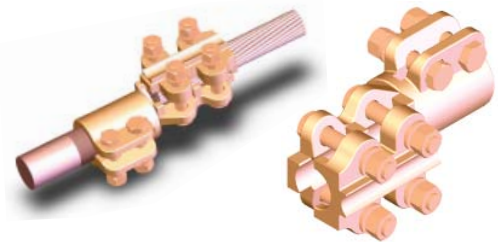

A strong and dependable connector for joining a threaded stud to a cable, the type BSC relies on a high conductivity copper alloy for its durability.

Clamping hardware is silicon bronze for resistance to corrosion.

For unthreaded studs or stud sizes not listed, please specify with the order.

Cables at 90 degree to the stud will be readily supplied but the suffix "-90" must appear at the end of the catalog number.

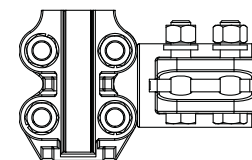
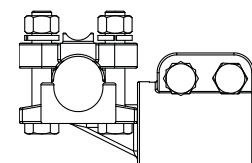
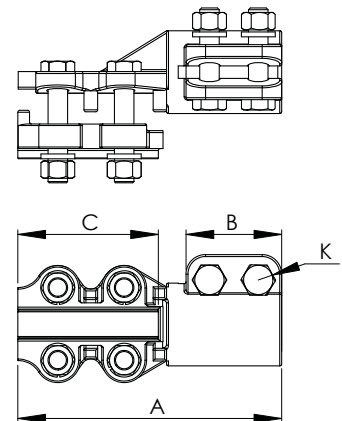

90 DEGREE
(USE SUFFIX -90)

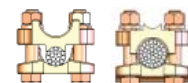

Wide Range denoted by: *