

BRONZE STUD CONNECTORS STUD TO BAR

SECTION

14-3

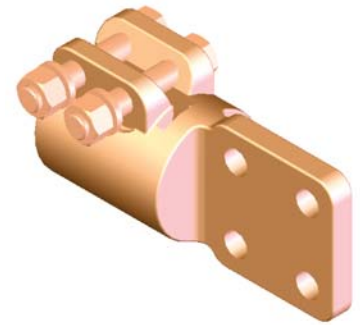

BRONZE STUD CONNECTORS STUD TO BAR						
CATALOG NUMBER	STUD SIZE	PAD STYLE	DIMENSIONS IN INCHES			
			A	B	C	K
14-326	1/2-13	B	5 7/8	2 7/8	3/8	3/8
14-327	1/2-13	C	5 7/8	2 7/8	3/8	3/8
14-328	1/2-13	D	6 7/8	2 7/8	3/8	3/8
14-329	3/4-16	B	5 7/8	2 7/8	3/8	3/8
14-330	3/4-16	C	5 7/8	2 7/8	3/8	3/8
14-331	3/4-16	D	6 7/8	2 7/8	3/8	3/8
14-332	1-14	B	5 1/2	2 1/2	1/2	3/8
14-333	1-14	C	5 1/2	2 1/2	1/2	3/8
14-334	1-14	D	6 1/2	2 1/2	1/2	3/8
14-336	1 1/8-12	B	5 1/2	2 1/2	1/2	3/8
14-337	1 1/8-12	C	5 1/2	2 1/2	1/2	3/8
14-338	1 1/8-12	D	6 1/2	2 1/2	1/2	3/8
14-341	1 1/4-12	B	6	3	1/2	1/2
14-342	1 1/4-12	C	6	3	1/2	1/2
14-343	1 1/4-12	D	7	3	1/2	1/2
14-346	1 1/2-12	B	6	3	1/2	1/2
14-347	1 1/2-12	C	6	3	1/2	1/2
14-348	1 1/2-12	D	7	3	1/2	1/2
14-351	1 3/4-12	B	6	3	1/2	1/2
14-352	1 3/4-12	C	6	3	1/2	1/2
14-353	1 3/4-12	D	7	3	1/2	1/2
14-356	2-12	B	6	3	1/2	1/2
14-357	2-12	C	6	3	1/2	1/2
14-358	2-12	D	7	3	1/2	1/2
14-362	2 1/4-12	B	6 3/8	3 3/8	1/2	1/2
14-363	2 1/4-12	C	6 3/8	3 3/8	1/2	1/2
14-364	2 1/4-12	D	7 3/8	3 3/8	1/2	1/2
14-368	2 1/2-12	B	6 3/8	3 3/8	3/4	1/2
14-369	2 1/2-12	C	6 3/8	3 3/8	3/4	1/2
14-370	2 1/2-12	D	7 3/8	3 3/8	3/4	1/2
14-373	2 3/4-12	B	6 5/8	3 5/8	3/4	5/8
14-374	2 3/4-12	C	6 5/8	3 5/8	3/4	5/8
14-375	2 3/4-12	D	7 5/8	3 5/8	3/4	5/8
14-378	3-12	B	6 7/8	3 7/8	3/4	5/8
14-379	3-12	C	6 7/8	3 7/8	3/4	5/8
14-380	3-12	D	7 7/8	3 7/8	3/4	5/8
14-384	3 1/4-12	B	6 7/8	3 7/8	3/4	5/8
14-385	3 1/4-12	C	6 7/8	3 7/8	3/4	5/8
14-386	3 1/4-12	D	7 7/8	3 7/8	3/4	5/8
14-390	3 1/2-12	B	7	4	1	5/8
14-391	3 1/2-12	C	7	4	1	5/8
14-392	3 1/2-12	D	8	4	1	5/8
14-396	4-12	B	7	4	1	5/8
14-397	4-12	C	7	4	1	5/8
14-398	4-12	D	8	4	1	5/8

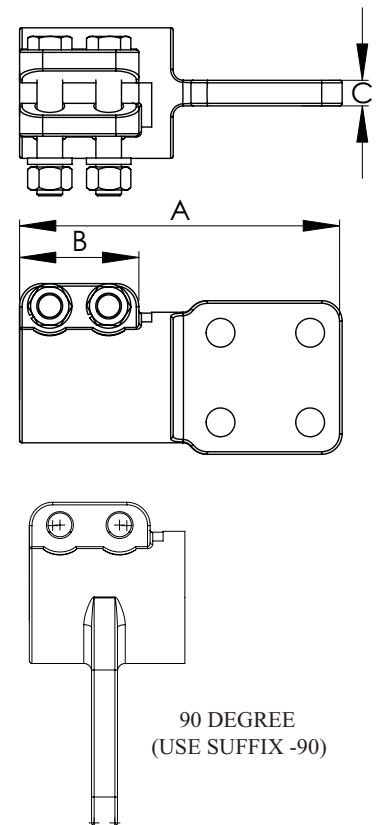

The BSTB which joins a threaded stud to a flat bar bus offers strength and durability because of its high conductivity copper alloy casting and silicon bronze clamping hardware.

Unthreaded studs or stud sizes not listed must be specified with the order.