

# BRONZE EXPANSION CONNECTORS STRAIGHT AND 90 DEGREE BENDS

SECTION

15-5

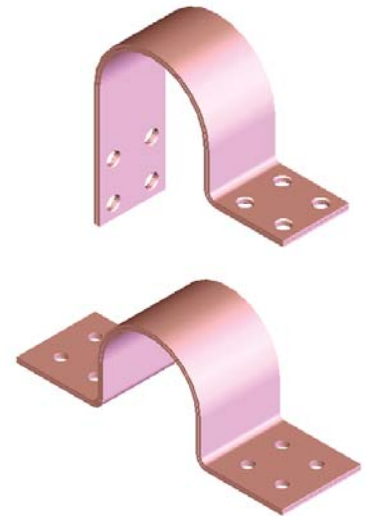
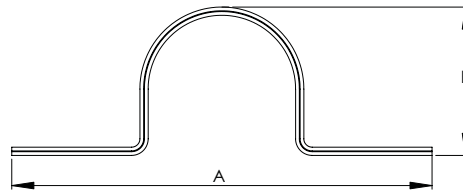
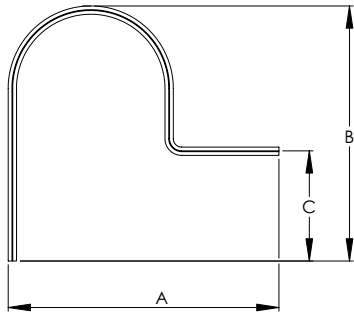

Made of a high conductivity copper, the Type BEB and Type BEB90 efficiently compensate for temperature variations and therefore protect equipment bushings, switch gear, and insulators from expanding or contracting pressures. The flexible shunts of laminated soft copper are designed to carry the maximum current listed.

Other current ratings are available upon request.



15-684-2000AMP

## BRONZE EXPANSION CONNECTORS STRAIGHT AND 90° EXPANSION BENDS

### STRAIGHT

| CATALOG NUMBER | PAD STYLE | DIMENSIONS IN INCHES |   | CURRENT RATING |
|----------------|-----------|----------------------|---|----------------|
|                |           | A                    | B |                |
| 15-679         | B         | 11                   | 6 | 400            |
| 15-680         | C         | 11                   | 6 | 690            |
| 15-681         | D         | 12                   | 6 | 900            |
| 15-682         | B         | 11                   | 8 | 640            |
| 15-683         | C         | 12                   | 8 | 970            |
| 15-684         | D         | 12                   | 8 | 1200           |

### 90°

| CATALOG NUMBER | PAD STYLE | DIMENSIONS IN INCHES |   |   | CURRENT RATING |
|----------------|-----------|----------------------|---|---|----------------|
|                |           | A                    | B | C |                |
| 15-685         | B         | 7                    | 9 | 3 | 400            |
| 15-686         | C         | 7                    | 9 | 3 | 690            |
| 15-687         | D         | 8                    | 9 | 4 | 900            |
| 15-688         | B         | 8                    | 9 | 3 | 640            |
| 15-689         | C         | 8                    | 9 | 3 | 970            |
| 15-690         | D         | 9                    | 9 | 4 | 1200           |