

BRONZE GROUND CLAMPS CABLE TO ROD OR PIPE, PARALLEL OR PERPENDICULAR

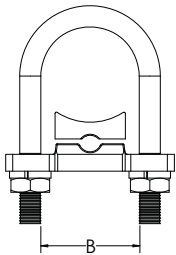

The type GCX is a cast electrical bronze grounding clamp whose purpose is to connect one cable, either parallel or perpendicular, to a ground rod or pipe.

For resistance to corrosion, all clamping hardware is stainless steel.

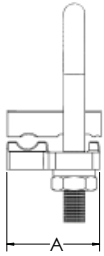
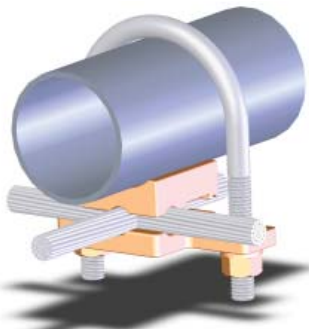

CATALOG NUMBER	ROD DIAM. IN INCHES	PIPE SIZE IPS	CABLE SIZE		DIMENSIONS IN INCHES		
			AWG MIN	MCM MAX	A	B	Hardware
17-200	1/2 - 3/4	1/4-3/8	8	4	1 3/8	7/8	3/8
17-201	1/2 - 3/4	1/4-3/8	4	2/0	1 3/8	7/8	3/8
17-202	1/2 - 3/4	1/4-3/8	2/0	250	1 1/2	7/8	3/8
17-203	1/2 - 3/4	1/4-3/8	250	500	1 1/2	7/8	3/8
17-204	7/8	1/2	8	4	1 1/2	1	3/8
17-205	7/8	1/2	4	2/0	1 1/2	1	3/8
17-206	7/8	1/2	2/0	250	1 1/2	1	3/8
17-207	7/8	1/2	250	500	1 1/2	1	3/8
17-208	1	3/4	8	4	1 1/2	1 1/8	3/8
17-209	1	3/4	4	2/0	1 1/2	1 1/8	3/8
17-210	1	3/4	2/0	250	1 7/8	1 1/8	3/8
17-211	1	3/4	250	500	1 7/8	1 1/8	3/8
17-212	1 1/4	1	8	4	1 1/2	1 1/4	3/8
17-213	1 1/4	1	4	2/0	1 1/2	1 1/4	3/8
17-214	1 1/4	1	2/0	250	1 1/2	1 1/4	3/8
17-215	1 1/4	1	250	500	1 1/2	1 1/4	3/8
17-216	1 1/2	1 1/4	8	4	1 3/8	1 3/4	3/8
17-217	1 1/2	1 1/4	4	2/0	1 3/4	1 3/4	3/8
17-218	1 1/2	1 1/4	2/0	250	1 3/4	1 3/4	3/8
17-219	1 1/2	1 1/4	250	500	1 3/4	1 3/4	3/8
17-220	1 1/2	1 1/4	500	750	1 3/4	1 3/4	3/8
17-221	2	1 1/2	8	4	1 3/8	2	3/8
17-222	2	1 1/2	4	2/0	1 3/4	2	3/8
17-223	2	1 1/2	2/0	250	1 3/4	2	3/8
17-224	2	1 1/2	250	500	1 3/4	2	3/8
17-225	2	1 1/2	500	750	1 3/4	2	3/8
17-226	2 1/2	2	8	4	1 3/4	2 1/2	3/8
17-227	2 1/2	2	4	2/0	1 3/4	2 1/2	3/8
17-228	2 1/2	2	2/0	250	1 3/4	2 1/2	3/8
17-229	2 1/2	2	250	500	3 1/2	2 1/2	3/8
17-230	2 1/2	2	500	750	2 3/4	2 1/2	3/8
17-231	3	2 1/2	8	4	1 3/4	3	3/8

Continued on next page

BRONZE GROUND CLAMPS CABLE TO ROD OR PIPE PARALLEL OR PERPENDICULAR, continued

SECTION

17-5

Continued from previous page

CATALOG NUMBER	ROD DIAM. IN INCHES	PIPE SIZE IPS	CABLE SIZE		DIMENSIONS IN INCHES		
			AWG MIN	MCM MAX	A	B	Hardware
17-232	3	2 1/2	4	2/0	1 1/2	3	3/8
17-233	3	2 1/2	2/0	250	1 3/4	3	3/8
17-234	3	2 1/2	250	500	3 1/2	3	3/8
17-235	3	2 1/2	500	750	1 3/4	3	3/8
17-236	3	2 1/2	750	1000	1 3/4	3	3/8
17-237	3 1/2	3	8	4	1 3/4	3 1/2	3/8
17-238	3 1/2	3	4	2/0	1 3/4	3 1/2	3/8
17-239	3 1/2	3	2/0	250	1 7/8	3 1/2	3/8
17-240	3 1/2	3	250	500	1 3/4	3 1/2	3/8
17-241	3 1/2	3	500	750	1 3/4	3 1/2	3/8
17-242	3 1/2	3	750	1000	1 3/4	3 1/2	3/8
17-243	4	3 1/2	8	4	1 3/4	4	3/8
17-244	4	3 1/2	4	2/0	1 7/8	4	3/8
17-245	4	3 1/2	2/0	250	1 7/8	4	3/8
17-246	4	3 1/2	250	500	1 7/8	4	3/8
17-247	4	3 1/2	500	750	1 7/8	4	3/8
17-248	4	3 1/2	750	1000	1 7/8	4	3/8
17-249	4 1/2	4	8	4	1 3/4	4 1/2	3/8
17-250	4 1/2	4	4	2/0	1 5/8	4 1/2	3/8
17-251	4 1/2	4	2/0	250	1 7/8	4 1/2	3/8
17-252	4 1/2	4	250	500	1 7/8	4 1/2	3/8
17-253	4 1/2	4	500	750	1 7/8	4 1/2	3/8
17-254	4 1/2	4	750	1000	1 7/8	4 1/2	3/8
17-255	5 1/2	5	8	4	1 3/4	5 7/8	3/8
17-256	5 1/2	5	4	2/0	1 3/4	5 7/8	3/8
17-257	5 1/2	5	2/0	250	1 7/8	5 7/8	3/8
17-258	5 1/2	5	250	500	1 7/8	5 7/8	3/8
17-259	5 1/2	5	500	750	1 7/8	5 7/8	3/8
17-260	5 1/2	5	750	1000	1 7/8	5 7/8	3/8
17-261	6 1/2	6	8	4	1 3/4	6 3/4	3/8
17-262	6 1/2	6	4	2/0	1 3/4	6 3/4	3/8
17-263	6 1/2	6	2/0	250	1 7/8	6 3/4	3/8
17-264	6 1/2	6	250	500	1 7/8	6 3/4	3/8
17-265	6 1/2	6	500	750	1 7/8	6 3/4	3/8
17-266	6 1/2	6	750	1000	1 7/8	6 3/4	3/8

