

ALUMINUM WELDMENT CONNECTORS EXPANSION COUPLER PIPE TO PIPE

SECTION

18-14

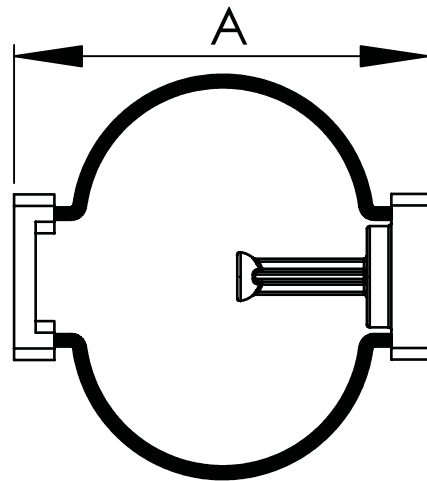

ALUMINUM WELDMENT CONNECTORS
EXPANSION COUPLER PIPE TO PIPE

CATALOG NUMBER	PIPE SIZE IPS	DIMENSIONS IN INCHES	
			A
18-1104	1/2		14
18-1105	3/4		14
18-1106	1		14
18-1107	1 1/4		14
18-1108	1 1/2		14
18-1109	2		14
18-1110	2 1/2		14
18-1111	3		14
18-1112	3 1/2		14
18-1113	4		14
18-1114	4 1/2		14
18-1115	5		14
18-1116	6		14

Cast of a lightweight and corrosion-resistant aluminum alloy, the economical Type WEC makes a permanent and reliable connection between pipe and offers protection for equipment bushings, switch gear, and insulators by compensating for expansion and contraction due to temperature variations. The flexible shunts of laminated soft aluminum are designed to carry the maximum current of the bus the connector joins. The aluminum shunts are factory welded into the castings.

