

SECTION

18-9

ALUMINUM WELDMENT CONNECTORS
CABLE TO FLAT PAD



A particularly reliable and economical connector for joining a cable to a flat bar bus, the Type WCP cast of a lightweight and corrosion resistant aluminum alloy makes a permanent connection.

Side formed NEMA pads are standard.

Any special tongue features will be readily supplied provided the catalog number is followed by the proper suffix. A 45½ tongue for catalog number 18-662, for instance, should be ordered as 18-662-45.

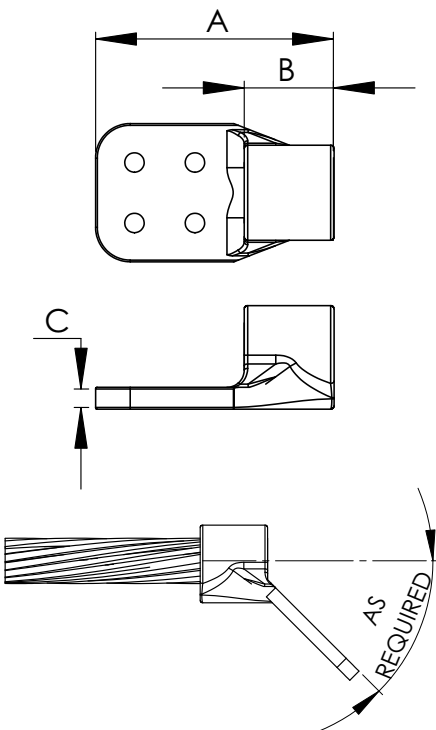

ALUMINUM WELDMENT CONNECTORS CABLE TO FLAT PAD							
CATALOG NUMBER	CABLE SIZE		PAD STYLE	DIMENSIONS IN INCHES			
	AAC	ACSR		A	B	C	
18-662	1/0	1/0	B	3 3/4	3/4	3/8	
18-663	1/0	1/0	C	3 3/4	3/4	3/8	
18-664	1/0	1/0	D	4 3/4	3/4	3/8	
18-665	2/0	2/0	B	3 3/4	3/4	3/8	
18-666	2/0	2/0	C	3 3/4	3/4	3/8	
18-667	2/0	2/0	D	4 3/4	3/4	3/8	
18-668	3/0	3/0	B	4	1	3/8	
18-669	3/0	3/0	C	4	1	3/8	
18-670	3/0	3/0	D	5	1	3/8	
18-671	4/0	4/0	B	4	1	3/8	
18-672	4/0	4/0	C	4	1	3/8	
18-673	4/0	4/0	D	5	1	3/8	
18-674	266.8	266.8	B	4	1	3/8	
18-675	266.8	266.8	C	4	1	3/8	
18-676	266.8	266.8	D	5	1	3/8	
18-677	336.4	336.4	B	4 1/2	1 1/4	3/8	
18-678	336.4	336.4	C	4 1/4	1 1/4	3/8	
18-679	336.4	336.4	D	5 1/4	1 1/4	3/8	
18-680	397.5	336.4	B	4 1/4	1 1/4	3/8	
18-681	397.5	336.4	C	4 1/2	1 1/4	3/8	
18-682	397.5	336.4	D	6	2	3/8	
18-683	477	397.5	B	4 3/4	1 1/4	7/16	
18-684	477	397.5	C	4 1/4	1 1/4	7/16	
18-685	477	397.5	D	5 1/4	1 1/4	7/16	
18-686	556.5	477	B	4 1/2	1 1/2	7/16	
18-687	556.5	477	C	5	1 1/2	7/16	
18-688	556.5	477	D	5 1/2	1 1/2	7/16	
18-689	636	556.5	B	4 1/2	1 1/2	7/16	
18-690	636	556.5	C	4 1/2	1 1/2	7/16	
18-691	636	556.5	D	5 1/2	1 1/2	7/16	
18-692	715.5	605	B	4 1/2	1 1/2	7/16	
18-693	715.5	605	C	4 1/2	1 1/4	7/16	
18-694	715.5	605	D	5 1/2	1 1/2	7/16	
18-695	795	636	B	4 3/4	1 1/2	7/16	
18-696	795	636	C	5	1 1/2	7/16	
18-697	795	636	D	6	1 1/2	7/16	
18-698	954	795	B	4 3/4	1 1/2	1/2	
18-699	954	795	C	4 3/4	1 3/4	1/2	
18-700	954	795	D	6	1 1/2	1/2	
18-701	1033.5	954 45/7	B	4 3/4	1 3/4	1/2	
18-702	1033.5	954 45/7	C	4 3/4	1 3/4	1/2	
18-703	1033.5	954 45/7	D	5 3/4	1 3/4	1/2	
18-704	1113	954 54/7	B	4 3/4	1 3/4	1/2	
18-705	1113	954 54/7	C	4 3/4	1 3/4	1/2	
18-706	1113	954 54/7	D	5 3/4	1 3/4	1/2	
18-707	1192.5	1033.5	B	5	2	1/2	
18-708	1192.5	1033.5	C	5	2	1/2	
18-709	1192.5	1033.5	D	6	2	1/2	
18-710	1272	1113	B	5	2	1/2	
18-711	1272	1113	C	5	2	1/2	
18-712	1272	1113	D	6 1/2	2	1/2	
18-713	1351.5	1272 45/7	B	5	2	9/16	
18-714	1351.5	1272 45/7	C	5	2	9/16	
18-715	1351.5	1272 45/7	D	6 1/2	2	9/16	
18-716	1431	1272 54/19	B	5	2	9/16	
18-717	1431	1272 54/19	C	5	2	9/16	
18-718	1431	1272 54/19	D	6	2	9/16	
18-719	1510.5	1351.3	B	5 1/2	2 1/2	9/16	
18-720	1510.5	1351.3	C	5 1/2	2 1/2	9/16	
18-721	1510.5	1351.3	D	6 1/2	2 1/2	9/16	
18-722	1590	1351.5	B	6	2 1/2	9/16	
18-723	1590	1351.5	C	6	2 1/2	9/16	
18-724	1590	1351.5	D	7	2 1/2	9/16	